



## Quick Reference Guide to Public Wi-Fi at PCH

Perth Children's Hospital provides a free Wi-Fi service to help patients, families and visitors stay connected.

The PCH Wi-Fi ('**HEALTH-Guest**' network) is accessible throughout the hospital. You do not require a password to connect to the hospital's free Wi-Fi.

### Accessing the internet

The way you connected to PCH Wi-Fi varies according to the device type. In all cases, make sure that your device is able to connect to Wi-Fi and has Wi-Fi turned on.

Note that you need to scroll to the bottom of the terms and conditions of use in order to accept or decline them.

## Android Devices

e.g. Samsung, Motorola or Google Phones and Tablets

- 1 Make sure your Wi-Fi is ON
- 2 Connect to the HEALTH-Guest network in your Wi-Fi settings
- 3 When prompted to Sign-in to the Wi-Fi network", touch the message.
- 4 Read the terms and conditions of use on the web page that opens and accept if you agree.
- 5 You should now be "Connected" to the HEALTH-Guest network, and have access to the internet.

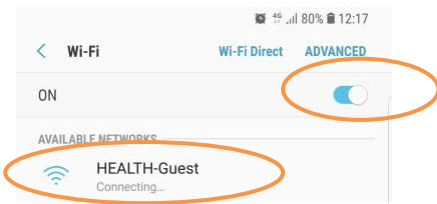

Wi-Fi settings screenshot showing Wi-Fi turned ON and HEALTH-Guest network selected under AVAILABLE NETWORKS.

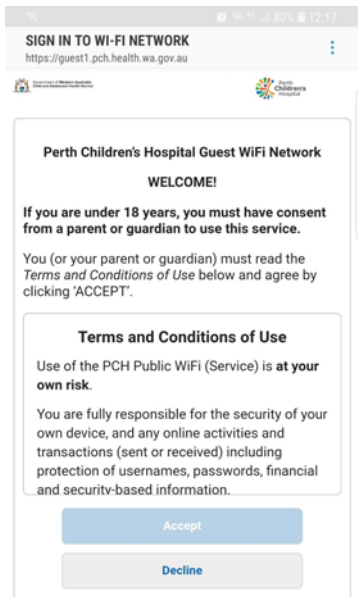

Sign-in page for the Perth Children's Hospital Guest WiFi Network, showing the terms and conditions of use.

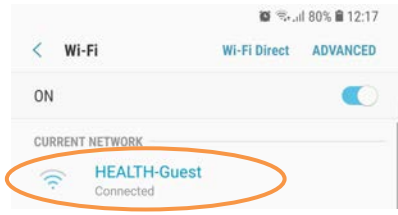

Wi-Fi settings screenshot showing Wi-Fi turned ON and HEALTH-Guest network selected under CURRENT NETWORK.



# Apple Devices

e.g. iPads and iPhones

- 1 Make sure your Wi-Fi is ON
- 2 Connect to the HEALTH-Guest network in your Wi-Fi settings
- 3 Open a browser e.g. Safari on your device, and browse to [www.google.com](http://www.google.com)
- 4 Read the terms and conditions of use on the web page that opens and accept if you agree.
- 5 You should now have access to the internet.

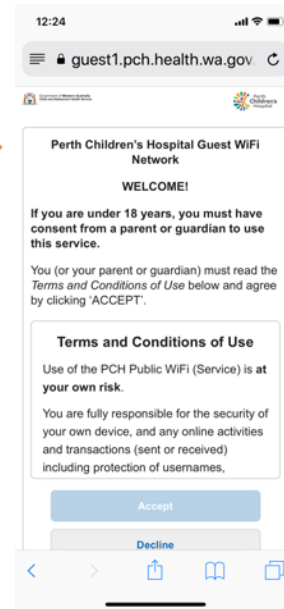
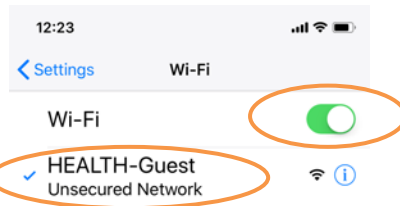

**Important**  
You will only be able to access the internet after accepting the terms and conditions of use for the PCH Wi-Fi.

# Windows Devices

e.g. most laptops

- 1 Make sure your Wi-Fi is ON
- 2 Connect to the HEALTH-Guest network in your Wi-Fi settings
- 3 Open a browser e.g. Chrome on your device, and browse to [www.google.com](http://www.google.com)
- 4 Read the terms and conditions of use on the web page that opens and accept if you agree.
- 5 You should now have access to the internet.

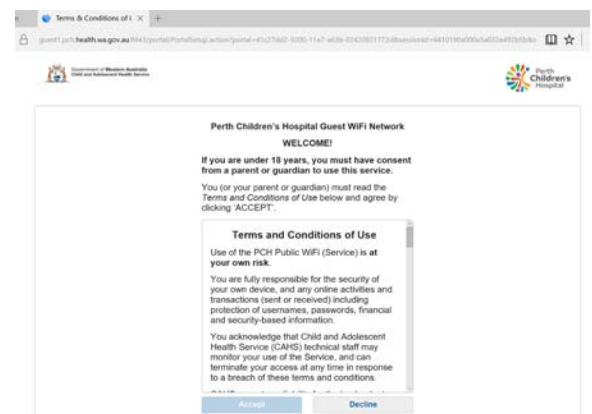
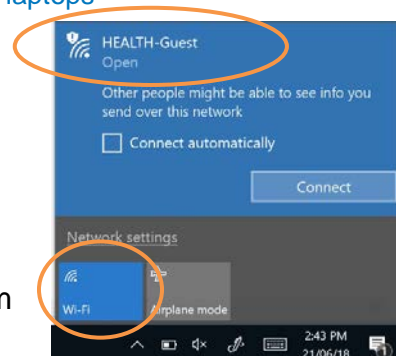

**Important**  
You will only be able to access the internet after accepting the terms and conditions of use for the PCH Wi-Fi.